

Geology on Mars | Grade 7



Materials in this unit are packaged in 1 box.

Hands-on materials

| Quantity | Description |
|----------|-------------------------|
| 1 | clay, non-drying, 16 oz |
| 20 | rock samples, basalt |
| 2 | trays, stream table |
| 20 | conglomerate rocks |
| 4 | sand, 2.5 kg bags |
| 1 | stream table kit |
| 20 | lenses, hand |
| 2 | clamp lamps |
| 2 | tubing, 4ft |
| 4 | buckets |

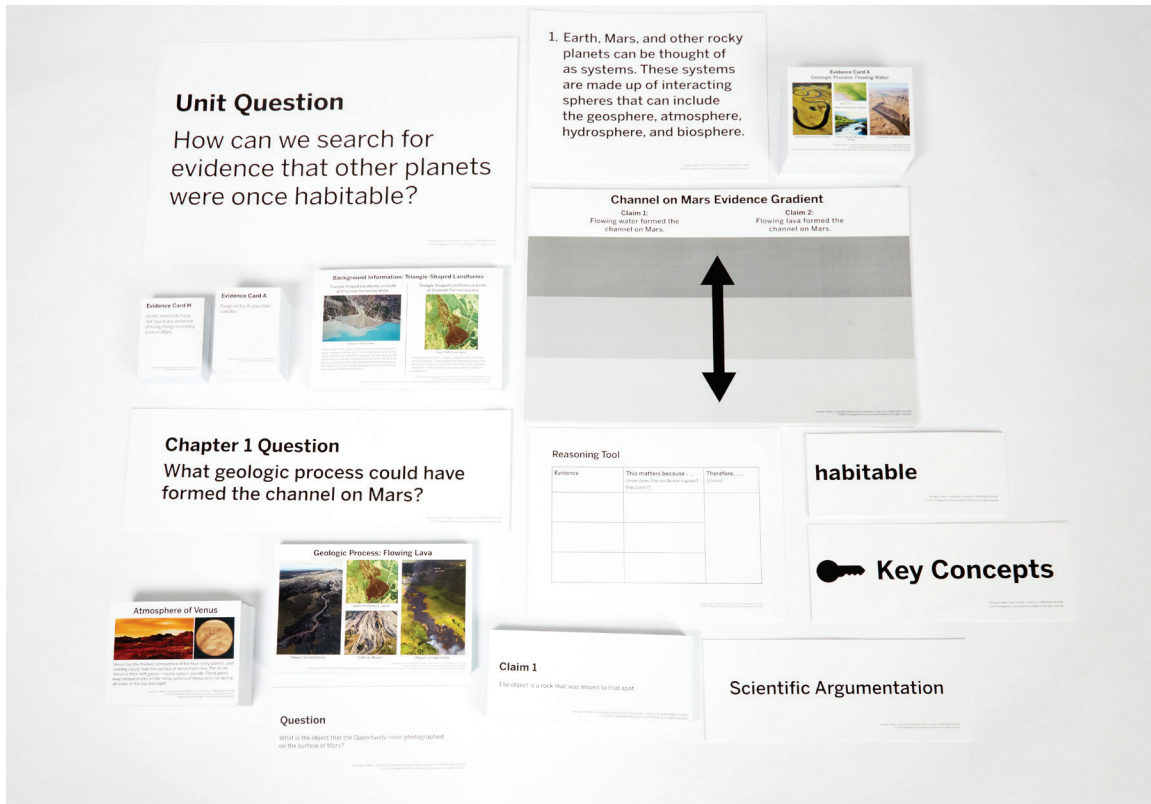

Classroom materials

| Quantity | Description | Quantity | Description |
|----------|---|----------|---|
| 2 | Scientific Argumentation Label and Scientific Argumentation Purpose cards | 20 sets | Jelly Donut Evidence cards: Set 2 (4 cards/set) |
| 3 | Evaluating Evidence Label and Evaluating Evidence Criterion cards | 10 sets | Comparing Rocky Planets cards (16 cards/set) |
| 1 | Components of a Written Scientific Argument card | 21 sets | Channel on Mars Evidence cards (6 cards/set) |
| 3 | Argumentation Sentence Starter cards | 21 sets | Background Information cards (2 cards/set) |
| 1 | Scientific Argument diagram | 20 sets | Geologic Processes cards (2 cards/set) |
| 1 | Evidence Gradient | 2 | Key Concepts and Vocabulary cards headers |
| 1 | Reasoning tool | 3 | Chapter Questions cards |
| 20 sets | Jelly Donut Question and Claim cards (3 cards/set) | 1 | Unit Question cards |
| 21 | Channel on Mars Evidence Gradient student sheets | 5 | Key Concepts cards |
| 20 sets | Jelly Donut Evidence cards: Set 1 (7 cards/set) | 10 | Vocabulary cards |

Plate Motion | Grade 7



Materials in this unit are packaged in 1 box.

Hands-on materials

| Quantity | Description |
|----------|---|
| 40 | transparencies, blank, 8.5" x 11", sheets |
| 40 | wet-erase markers, black |
| 20 | Silly Putty, containers |
| 40 | wet-erase markers, red |
| 20 | cubes, 1", plastic |
| 20 | towels |

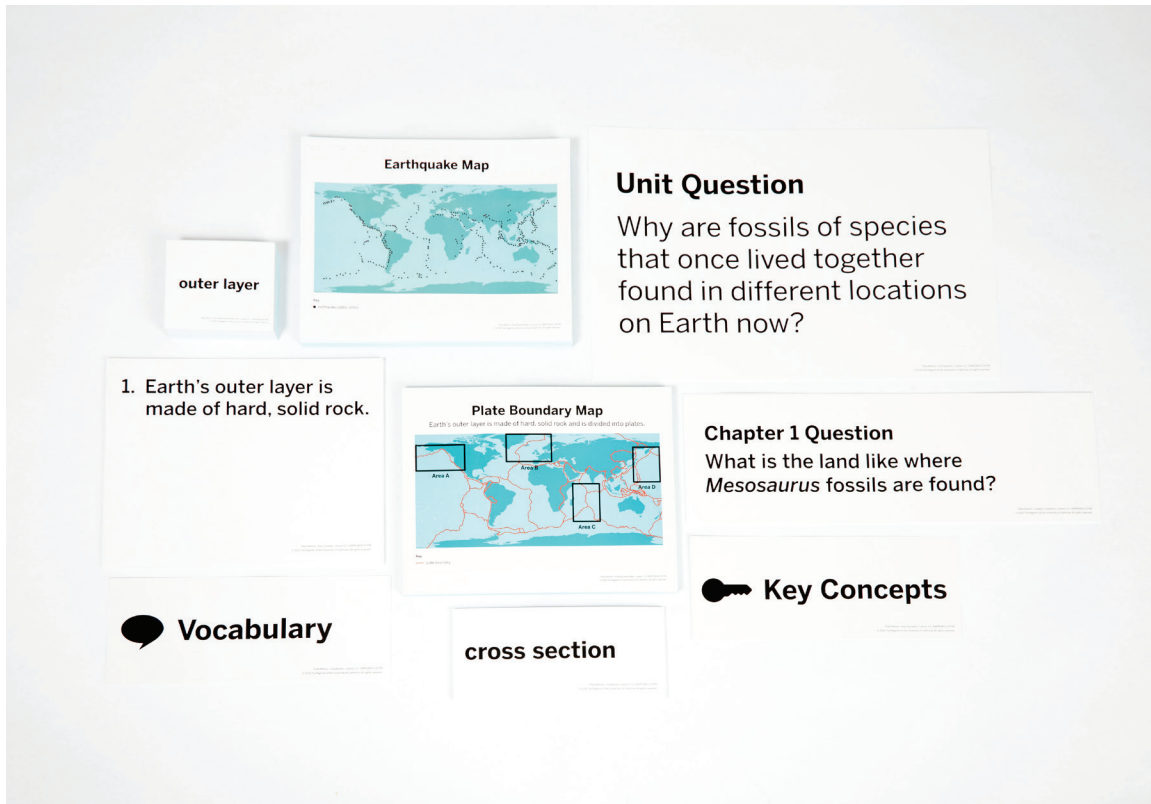

Classroom materials

| Quantity | Description |
|----------|--|
| 10 sets | Word Relationship cards: set 1 (4 cards/set) |
| 10 sets | Word Relationship cards: set 2 (2 cards/set) |
| 20 | Plate Boundary Map cards |
| 20 | Earthquake Map cards |
| 2 | Key Concepts and Vocabulary cards headers |
| 4 | Chapter Questions cards |
| 9 | Key Concepts cards |
| 1 | Unit Question card |
| 14 | Vocabulary cards |

Plate Motion: Engineering Internship | Grade 7



Materials in this unit are packaged in 1 box.

Hands-on materials

| Quantity | Description |
|----------|---|
| 8 | transparencies, blank, 8.5" x 11", sheets |
| 64 | plastic buildings, miniature |
| 2 | tape, packing, clear, rolls |
| 200 | straws, flexible, wrapped |
| 8 | paint trays |

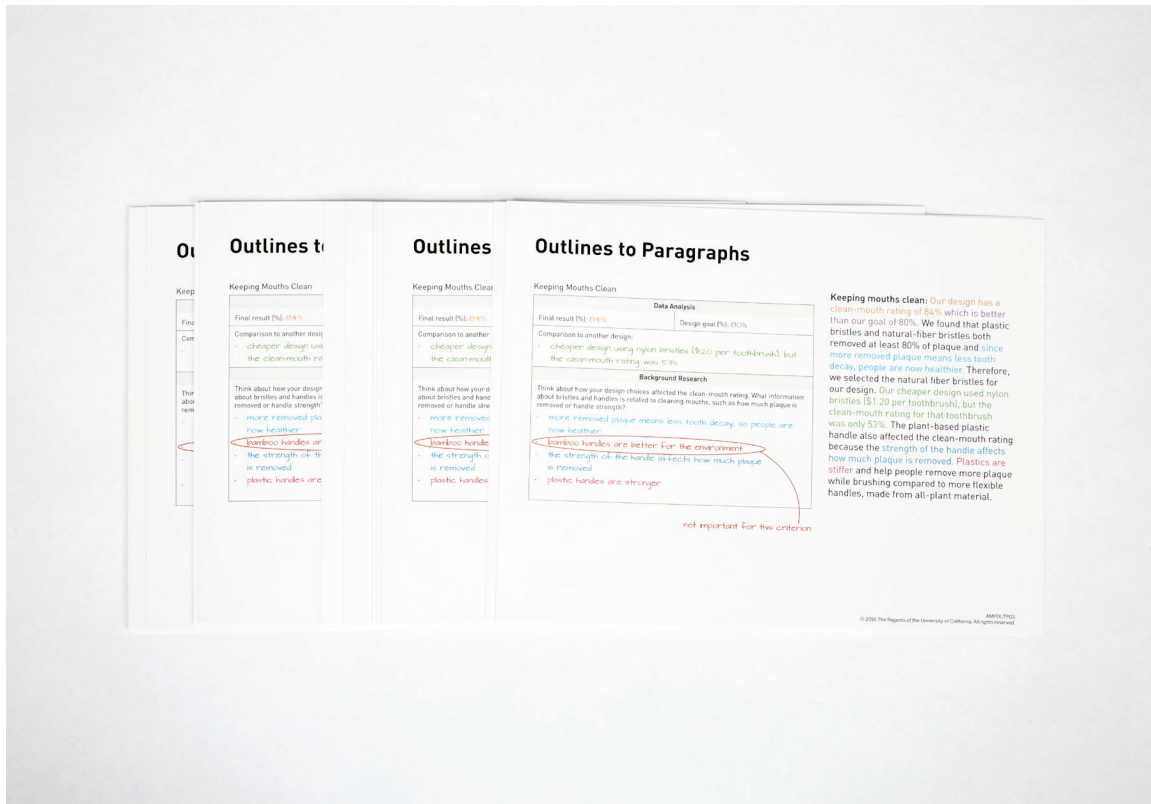

Classroom materials

| Quantity | Description |
|----------|-------------------------------|
| 20 | outlines to paragraphs sheets |

Rock Transformations | Grade 7



Materials in this unit are packaged in 1 box.

Hands-on materials

| Quantity | Description |
|----------|---|
| 10 | rock sets: granite, basalt, sandstone, conglomerate |
| 3 | baggies, plastic with zip, gallon |
| 20 | lids, for plastic containers |
| 20 | containers, plastic, clear |
| 200 | cups, plastic, 3 oz |
| 10 | conglomerate rocks |
| 300 | hard candies |
| 10 sets | sandstone |
| 10 sets | granite |
| 10 sets | basalt |
| 40 | dice |

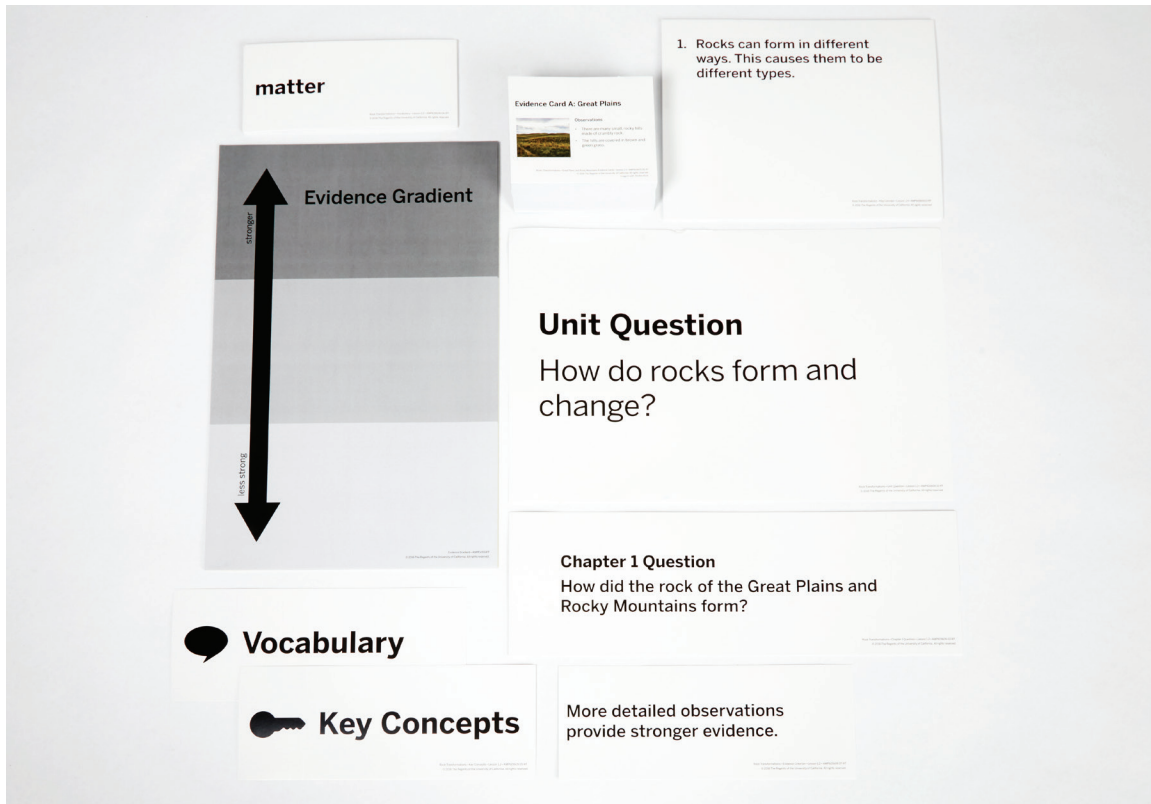

Classroom materials

| Quantity | Description |
|----------|---|
| 20 sets | Great Plains and Rocky Mountains Evidence Cards (8 cards/set) |
| 20 | Evidence Gradient cards |
| 2 | Key Concepts and Vocabulary cards headers |
| 4 | Chapter Questions cards |
| 1 | Evidence Criterion card |
| 1 | Unit Question card |
| 11 | Key Concepts cards |
| 15 | Vocabulary cards |

Phase Change | Grade 7



Materials in this unit are packaged in 1 box.

Hands-on materials

| Quantity | Description |
|----------|---------------------------------|
| 120 | marbles, magnetic, low-strength |
| 20 | containers, plastic clamshell |
| 500 | Isopropanol alcohol, bottles |
| 2 | cylinders, graduated, 50 mL |
| 50 | cups, plastic, 9 oz |
| 10 | cups, foam, 8 oz |
| 40 | dropper bottles |
| 1 | scale, digital |
| 20 | lenses, hand |

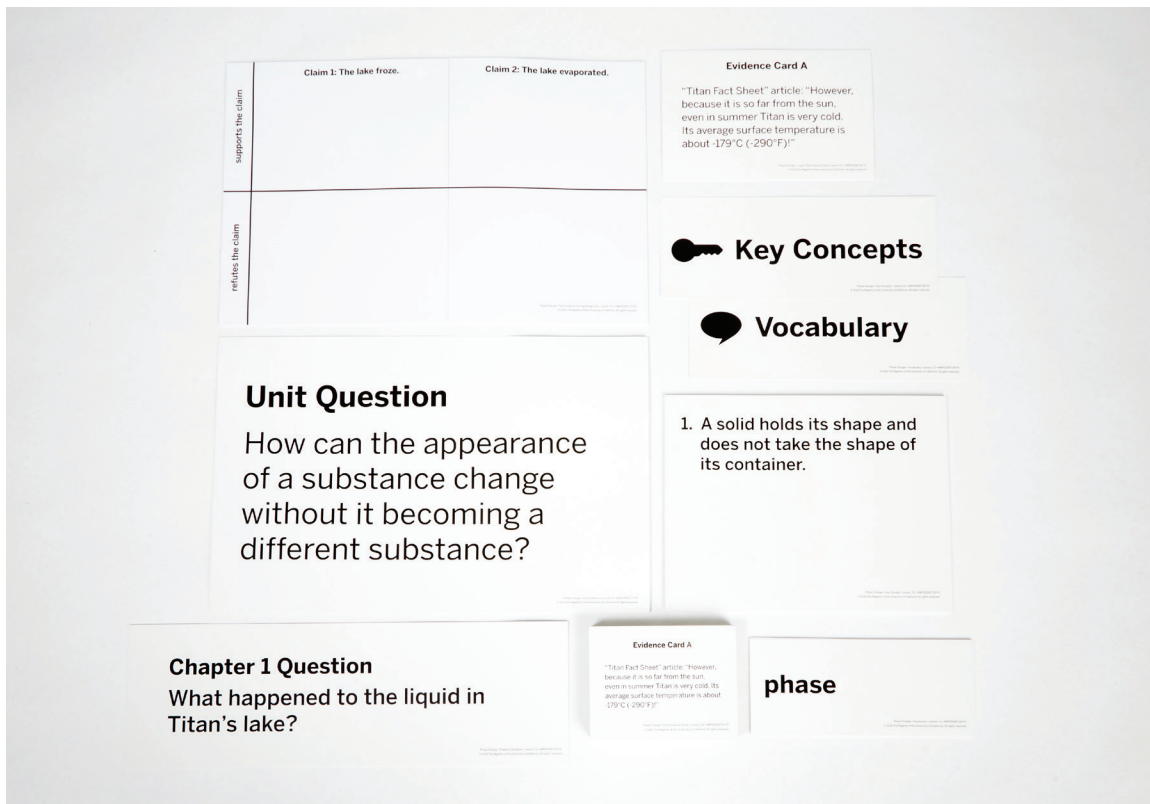

Classroom materials

| Quantity | Description |
|----------|---|
| 20 | Titan Evidence Sorting Background cards |
| 20 sets | Titan Evidence cards (4 cards/set) |
| 4 | Large Titan Evidence Cards |
| 2 | Key Concepts and Vocabulary cards headers |
| 4 | Chapter Questions cards |
| 16 | Key Concepts cards |
| 1 | Unit Question card |
| 8 | Vocabulary cards |

Phase Change: Engineering Internship | Grade 7



Materials in this unit are packaged in 1 box.

Hands-on materials

| Quantity | Description |
|----------|-------------|
| 50 | handwarmers |
| 1 | tongs |

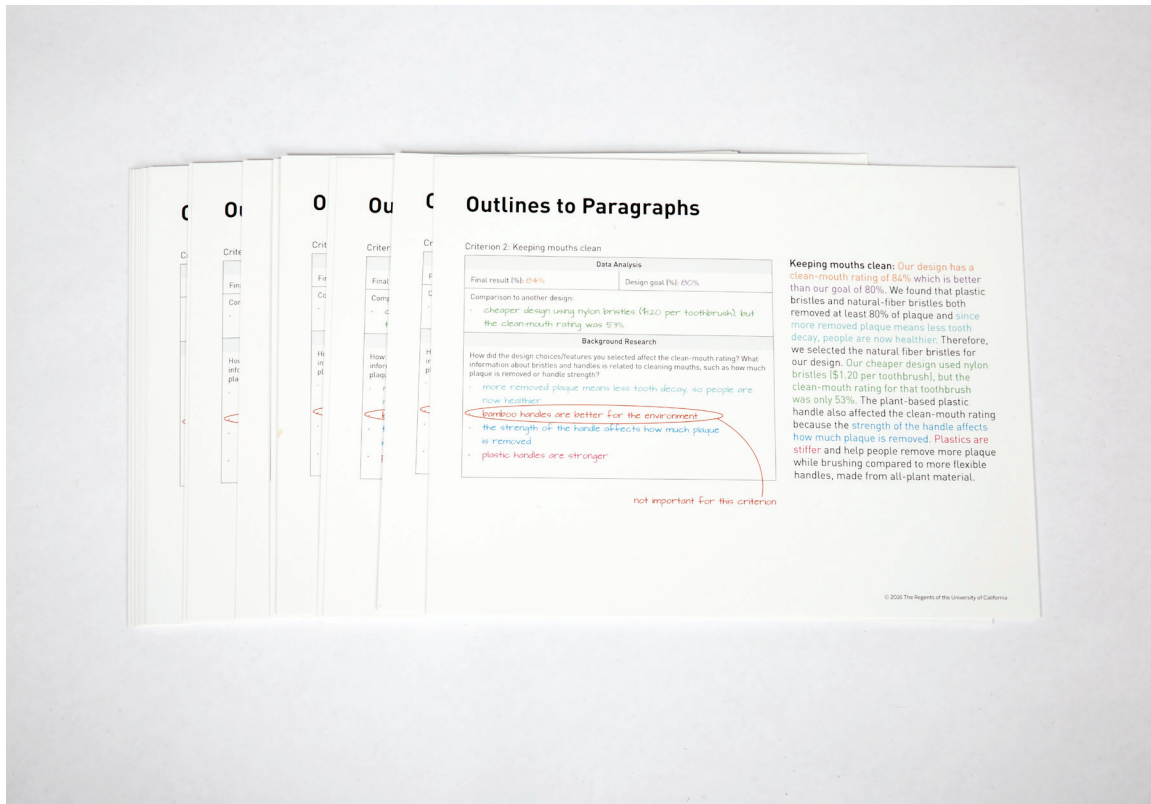

Classroom materials

| Quantity | Description |
|----------|-------------------------------|
| 20 | Outlines to Paragraphs sheets |

Chemical Reactions | Grade 7



Materials in this unit are packaged in 1 box.

Hands-on materials

| Quantity | Description | Quantity | Description |
|----------|---|----------|-----------------------------|
| 184 | labels for vials ["pipe substance" (30), "fertilizer" (30), "reddish-brown substance" (10), "sample 1" (10), "sample 2" (10), "sample 3" (10), "sample 4" (10), "well water" (1), "water from pipes" (1), "calcium chloride" (11), "sodium carbonate" (11), "product" (50)] | 160 | tokens (plastic), green |
| 164 | sodium carbonate powder, anhydrous, grams | 160 | tokens (plastic), white |
| 10 | sodium chloride (table salt), tbsp | 140 | tokens (plastic), blue |
| 1 | cylinder, graduated, 25 mL | 20 | tokens (plastic), gray |
| 10 | potassium chloride powder, tbsp | 11 | sodium nitrate powder, tbsp |
| 72 | vials, plastic, with lid | 200 | tokens (plastic), red |
| 240 | tokens (plastic), purple | 150 | cups, plastic, 9 oz |
| 20 | tokens (plastic), yellow | 11 | Iron oxide granules, tbsp |
| 164 | calcium chloride, grams | 1 | measuring spoon |
| 1 | funnel (plastic), small | 10 | graphite powder, tbsp |
| 120 | tokens (plastic), amber | 1 | measuring cup |
| | | 10 | Iron filings, tbsp |
| | | 10 | cornstarch, tbsp |

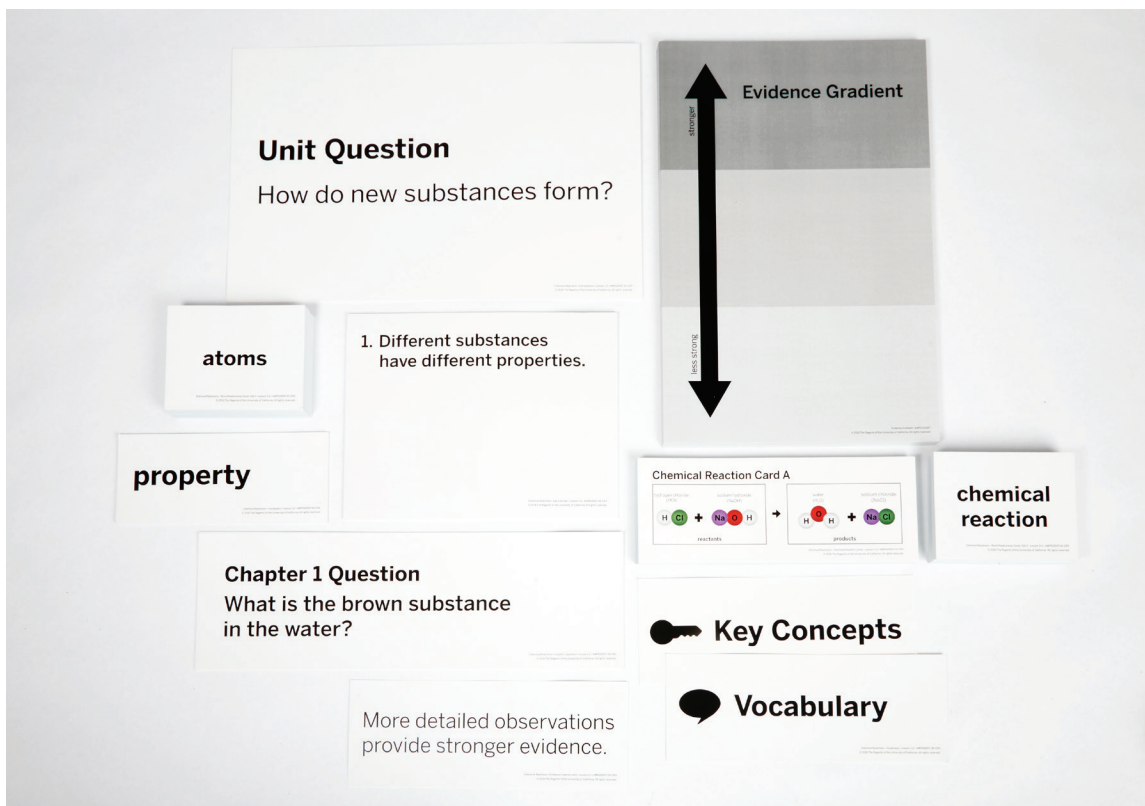

Classroom materials

| Quantity | Description |
|----------|---|
| 20 sets | Word Relationships cards: set 1 (4 cards/set) |
| 20 sets | Word Relationships cards: set 2 (4 cards/set) |
| 20 sets | Chemical Reaction cards (2 cards/set) |
| 20 | Evidence Gradient cards |
| 2 | Key Concepts and Vocabulary cards headers |
| 4 | Chapter Questions cards |
| 1 | Evidence Criterion card |
| 9 | Key Concepts cards |
| 1 | Unit Question card |
| 9 | Vocabulary cards |

Populations and Resources | Grade 7



Materials in this unit are packaged in 1 box.

Hands-on materials

| Quantity | Description |
|----------|-------------------------------|
| 20 | measuring spoons, 1 tbsp |
| 10 | cylinders, graduated, 50 mL |
| 60 | sugar, white, granulated, tsp |
| 250 | cups, plastic, 16 oz |
| 150 | wooden craft sticks |
| 20 | cups, plastic, 9 oz |
| 520 | tokens, plastic |
| 200 | yeast, baker's, tbsp |
| 1 | thermometer |

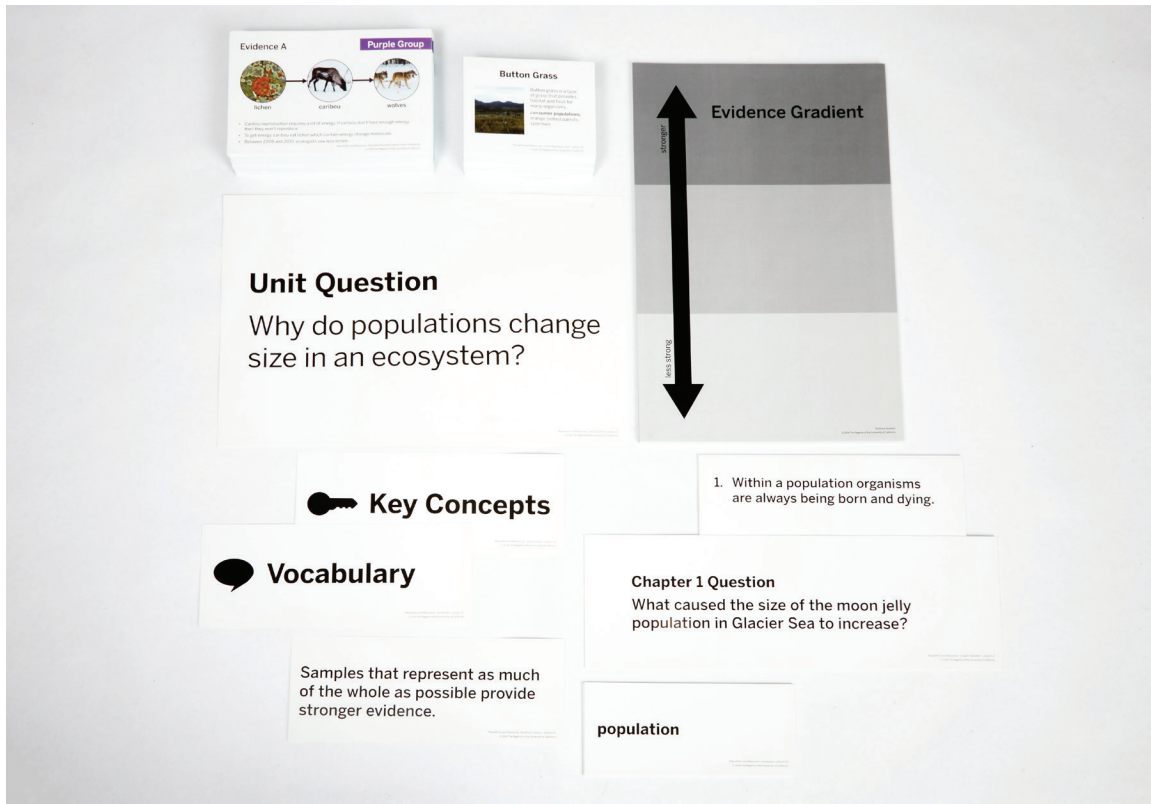

Classroom materials

| Quantity | Description |
|----------|---|
| 20 sets | Population Puzzles Evidence Cards (6 cards/set) |
| 14 sets | Island Population cards (9 cards/set) |
| 20 | Evidence Gradient cards |
| 2 | Key Concepts and Vocabulary cards headers |
| 4 | Chapter Questions cards |
| 1 | Evidence Criterion card |
| 1 | Unit Question card |
| 11 | Key Concepts cards |
| 11 | Vocabulary cards |

Matter and Energy in Ecosystems | Grade 7



Materials in this unit are packaged in 1 box.

Hands-on materials

| Quantity | Description |
|----------|---------------|
| 600 | carbon tokens |
| 470 | paper clips |

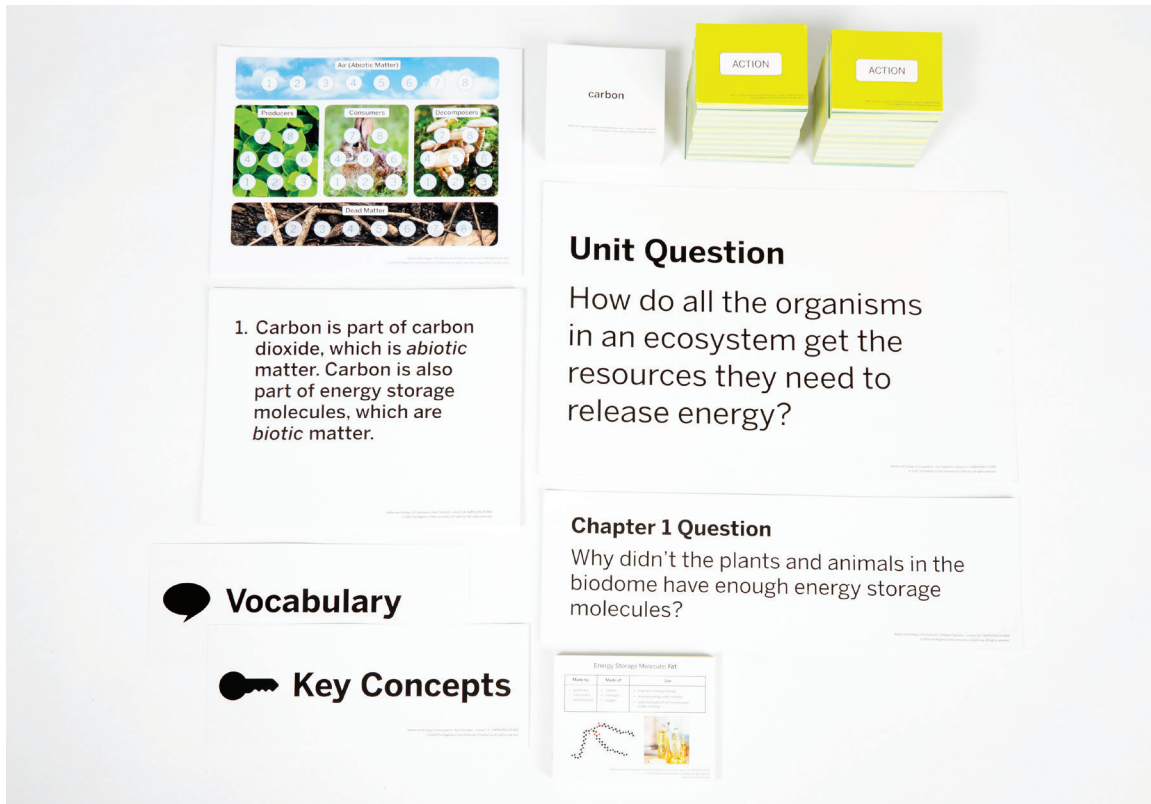

Classroom materials

| Quantity | Description |
|----------|--|
| 10 sets | Energy Storage Molecules cards (4 cards/set) |
| 10 sets | Word Relationships card set (12 cards/set) |
| 20 sets | Carbon Game cards (27 cards/set) |
| 20 | Carbon Game boards |
| 2 | Key Concepts and Vocabulary cards headers |
| 4 | Chapter Questions cards |
| 1 | Unit Question card |
| 13 | Vocabulary cards |
| 10 | Key Concepts |